

Series 12-112 /12-132

Air Filter Regulator

Type 12-112 and 12-132 with direct valve control

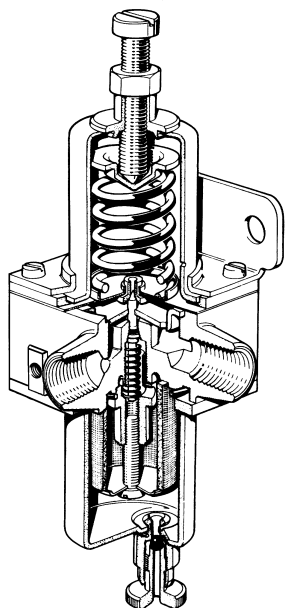

Description:

These air filter regulators, available with or without a pressure gauge, are suitable for direct mounting into the line or if provided with a fastening plate, for flush or surface mounting.

In spite of the small dimensions and the direct control of the valve by means of an adjusting spring and a diaphragm, the air filter regulator delivers a considerable quantity of reduced air, because a special device in the diaphragm chamber guides the flow of air. Besides the diaphragm is provided with a small outlet, which under normal conditions, is accurately closed by the plug. As soon as conditions arise by which a higher secondary pressure is obtained, the diaphragm resp. the outlet are moved immediately and comes free from the plug so that an opening is formed through which the over pressure is blown off. The same also happens when, under working conditions, a lower secondary pressure is adjusted.

Application:

For regulating air, resp. non-aggressive or non-explosive gases under pressure according to the characteristics, which are shown in both graphics 1 and 2.

Material:

Spindle and lock nut	: Stainless steel
Nut for spindle	: Brass
Spring barrel	: Stainless steel
Fastening plate	: Stainless steel
Adjusting spring	: Steel (coated)
Plug	: Stainless steel
Seat	: Brass
Body	: Brass

Filter casing	: Stainless steel
Filter	: Stainless steel threshold value 30 micron
Drain plug	: Brass
Diaphragm	: EFFB (Neoprene with nylon reinforcement)
O-rings	: NBR 70°shore
Handle	: Plastic (optional)

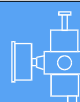

Series

12-112

12-132

Output air pressure

Article number

Article number

0 - 4 bar

A1121306

A112130625

with pressure gauge 0 - 2.5 bar

0 - 4 bar

A11213064

with pressure gauge 0 - 4 bar

0 - 7 bar

A1121309

A11213096

with pressure gauge 0 - 6 bar

0 - 7 bar

A112130910

with pressure gauge 0 - 10 bar

Options:

* With handle (series 12-115 and 12-135)

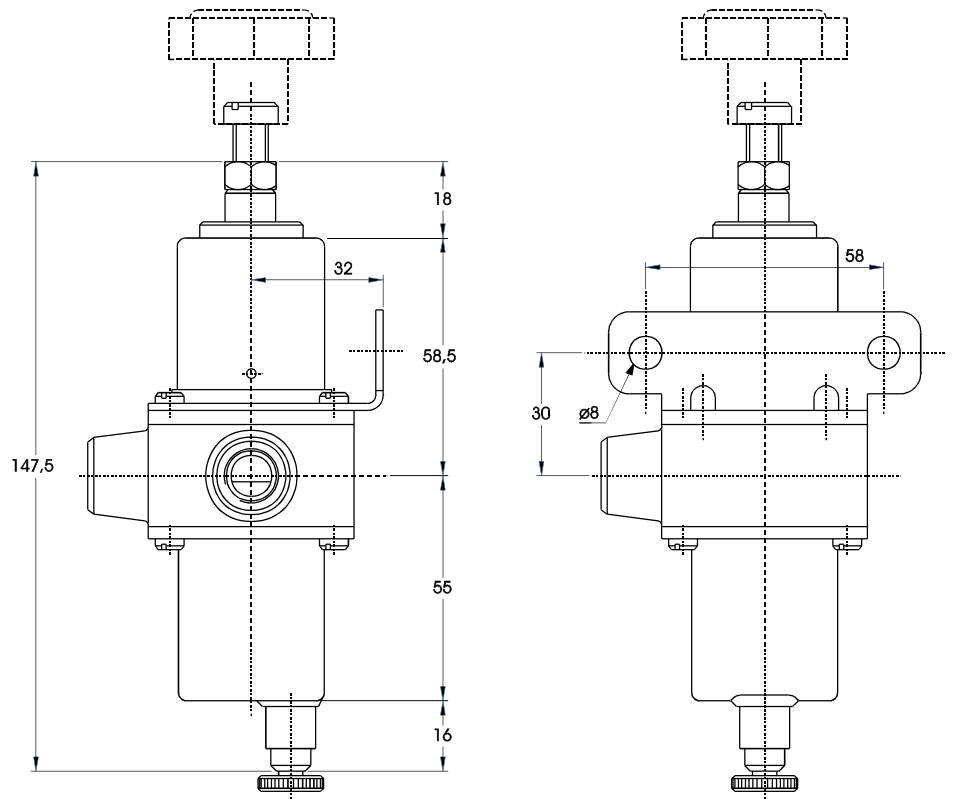

Technical data:

- Air supply** : max. 10 bar
- Output air pressure adjustable** : with adjusting spring 1 from 0 - 3.5 bar
: with adjusting spring 2 from 0 - 7.0 bar
- Flow capacity** : max. 40m³/h see graphic 1
- Supply pressure sensitivity** : see graphic 2
- Thread connections** : ¼" NPT female

maten in mm.

Graphic 1

Cap. in NM³/h ----- free flow by

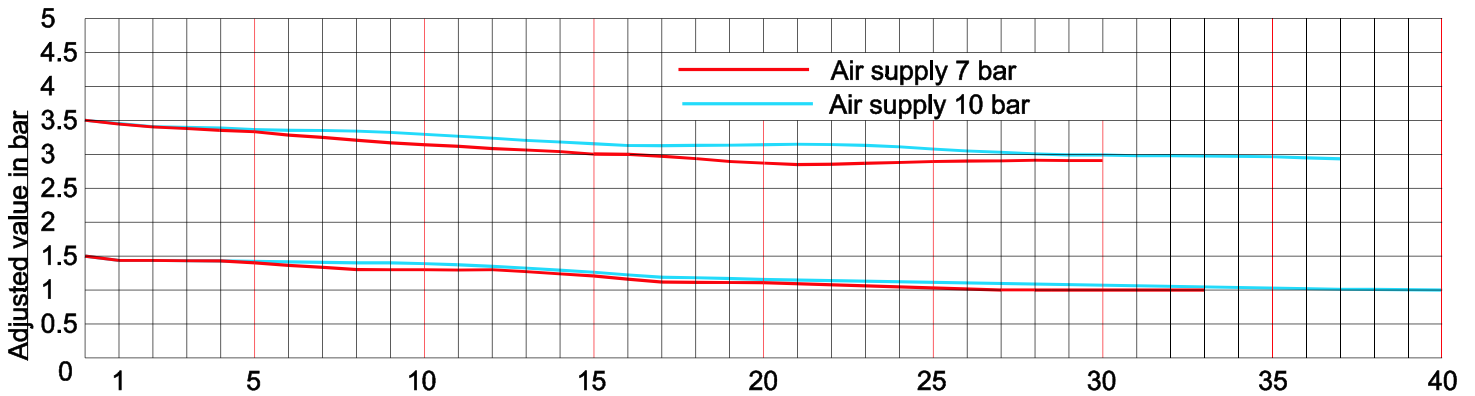

Graphic 2

Decrease of the secondary pressure by increasing the air supply

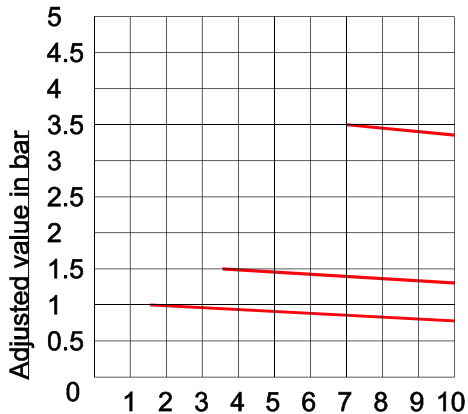

E.N.F.M. Instruments B.V.
 Nieuwpoortweg 10
 3125 AP Schiedam
 Postbus 148
 3100 AC Schiedam
 The Netherlands
 Tel.: +31 (0)10 - 4373799
 Fax.: +31 (0)10 - 4152631
 E-mail: info@enfm.nl
 Homepage: http://www.enfm.net